

Capresso



Blade Grinder

Model #504

- Operating Instructions
- Product Registration
- Warranty

120 W / 120Vac / 60Hz

IMPORTANT SAFEGUARDS

When using this grinder, basic safety precautions should always be followed including the following:

1. Read all instructions
 2. Unplug from outlet when not in use, before putting on or taking off parts and before cleaning.
 3. Check the grinding cup for presence of foreign objects before using. Place the cover on before turning the grinder on.
 4. Do not pull the power cord from the unit. Unwind the cord from the cord storage on the bottom of the unit. (fig.5)
 5. Do not take off the cover before the blade has come to a complete standstill. Avoid contact with moving parts.
 6. Clean the ground coffee container after every use. NEVER immerse the appliance in water or other liquid. Do not rinse under running water. You can clean the appliance with a damp cloth after removing the plug from the outlet.
 7. Do not operate the coffee grinder for longer than 1 minute continuously as this could cause overheating. Let the motor cool down for 10-15 minutes after long operation before you continue.
 8. Do not operate the appliance with a damaged cord or plug or after the appliance malfunctions, or is dropped or damaged in any manner. Return appliance to the nearest authorized service facility for examination, repair or electrical or mechanical adjustment.
 9. Indoor use only. Do not use outdoors.
 10. Close supervision is necessary when the appliance is used by or near children.
 11. Do not let cord hang over edge of table or counter.
 12. Do not let cord contact hot surface, including the stove.
 13. FOR HOUSEHOLD USE ONLY
-

SPECIAL CORD SET INSTRUCTIONS

Regarding your cord set:

- A. A short power-supply cord (or detachable power-supply cord) is to be provided to reduce risks resulting from becoming entangled in or tripping over a longer cord.
- B. Longer detachable power-supply or extension cords are available and may be used if care is exercised in their use.
- C. If a long detachable power-supply cord or extension cord is used,
 - 1) The marked electrical rating of the detachable power-supply cord or extension cord should be at least as great as the electrical rating of the appliance,
 - 2) If the appliance is of the grounded type, the extension cord should be a rounding type 3-wire cord, and
 - 3) The longer cord should be arranged so that it will not drape over the counter top or table top where it can be pulled on by children or tripped over.
- D. This appliance has a polarized plug (one blade is wider than the other). As a safety feature, this plug will fit in a polarized outlet only one way. If the plug does not fit fully in the outlet, reverse the plug. If it still does not fit, contact a qualified electrician. Do not attempt to defeat this safety feature.

Capresso Blade Grinder

Thank you for buying the Capresso blade grinder. Freshly ground coffee yields more aroma and flavor. Please read the following instructions to make the best use of this grinder. This blade grinder can also be used to grind dried herbs and spices. Do not grind any herbs or spices that are too hard or long like cinnamon bark or nutmeg. Flavor transfers may occur between coffee and spices depending on usage. Ensure grinder is always clean or use second grinder if you grind both spices and coffee regularly.

How To Operate

1. Unwind cord. Make sure the grinder sits on a flat surface.
2. Remove lid and fill the grinding chamber with beans. (fig. 2)

3. Place the cover back onto unit (fig. 3).
4. Insert the plug into the power outlet.
5. Hold the coffee grinder with one hand, press and hold the on/off switch (A) with your other hand (fig. 4). It will take approximately 20 to 30 seconds to grind 1/3 cup of coffee. For best results grind in 10 second intervals (pulse).
6. As soon as you release the on/off switch (A) the grinding blades will stop rotating.
7. When grinding is finished, unplug machine, slowly remove the lid. Remove all of the ground coffee from the bean container. Clean grinder after each use.
8. You can store the power cord by winding it around the bottom of the unit. (fig. 5)

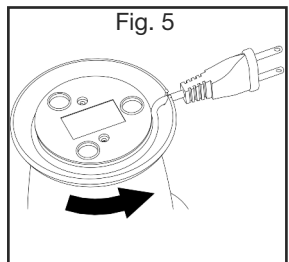
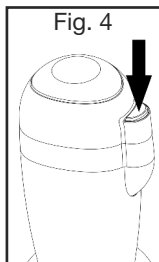
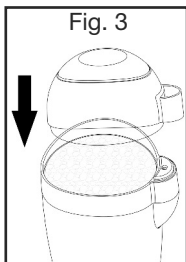
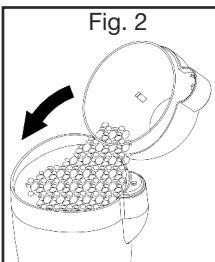
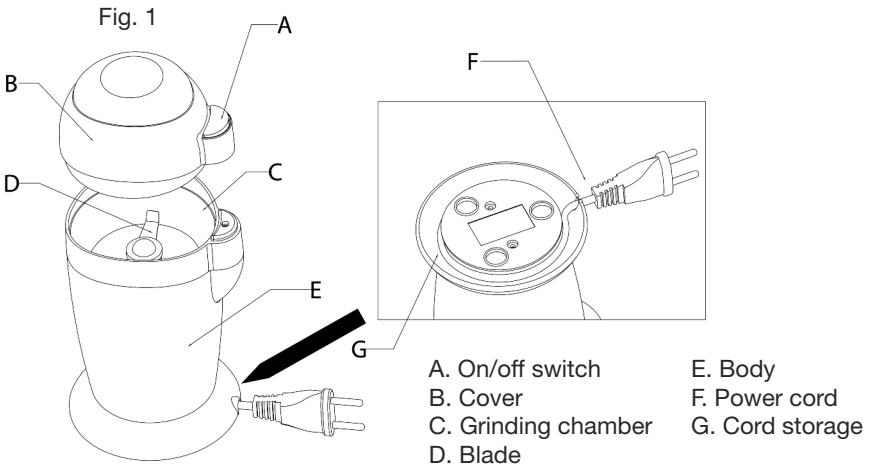

How To Clean The Appliance

1. Unplug before cleaning.
2. Empty the bean container. Wipe the inside of the container with a damp cloth.
CAUTION: Blade is sharp, use care when cleaning.
3. Wipe the outside housing and the lid with a damp cloth.
4. Never use wet cloth to clean the appliance. NEVER IMMERSER MACHINE IN ANY LIQUID.

Limited Warranty

This warranty covers your Capresso grinder, models #504. The model # can be found on the bottom of the machine. This warranty is in effect for one year from the date of the first consumer purchase. This warranty covers all defects in materials or workmanship (parts and labor).

This warranty does not cover:

- Any machine not purchased from an Authorized JURA Dealer.
- Damage caused by accident, abuse, negligence, misuse, improper operation or failure to follow instructions container in this manual.

- Any service or alteration performed by an unauthorized person, company or association.

Other limitations and exclusions: Any implied warranties including fitness for use and merchantability are limited in duration to the period of the express warranty set forth above and no person is authorized to assume for JURA any other liability in connection with the sale of the machine. JURA expressly disclaims liability for incidental and consequential damages caused by the machine. The term "incidental damages" refers to the loss of the original purchasers time, loss of the use of the machine or other costs relating to the care and custody of the machine. The term "consequential damages" refers to the cost of repairing or replacing other property which is damaged when this machine does not work properly. The remedies provided under this warranty are exclusive and in lieu of all others. This warranty gives you specific legal rights, and you may also have other rights which vary from state to state.

Customer Service

1-800-767-3554

Mon-Thu 8AM – 9PM • Fri 8AM – 8PM • Sat 9AM – 5PM

Eastern Time Zone

contact@capresso.com

JURA Inc.

20 Craig Road, Montvale, NJ 07645

201-767-3999 • Fax: 201-767-9684

Website: www.capresso.com